

WPANT10064

Dual-band Wi-Fi / WLAN Antenna

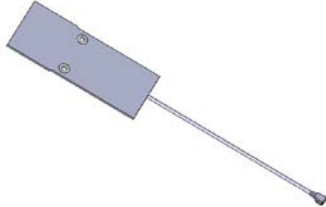

WPANT10064-S1A

5" micro co-ax with IPX MHF connector

Note: Different cable and connector style requests can be accommodated.

Application

A sleek plug and play antenna for 2.4 GHz and 5 GHz Wi-Fi / WLAN frequencies. This antenna works very well on any metallic or non-metallic surface.

We can assist your engineers to optimize mounting positions for these antennas in your specific application and can further assist to troubleshoot system integration issues such as TRP/TIS and FCC requirements. We specialize in developing customized Antenna solutions. Please contact sales@worldproducts.com with your specific application requirements.

Electrical Properties

Operating Frequency	2.4 – 2.5 GHz	4.9 – 5.9 GHz
Approximate Antenna Impedance [Ω]	50 Ω	50 Ω
VSWR (Typical)	< 2:1	< 2:1
Peak Gain [dBi] (Typical)	2 dBi	3 dBi
Efficiency [%] (Typical)	80 %	70 %
Polarization	Linear	Linear
Pattern	Near Omni-directional	Near Omni-directional

Mechanical / Environmental Properties

Antenna Dimensions	2" x 0.87" x 0.031" (50mm x 22mm x 0.78mm)
Antenna Color	Black
Operating / Storage Temperature	-40°C to +125°C
Environmental	Meets standards for UL 94V-0
Hazardous Materials	RoHS Compliant

Picture

